

REINFORCING RODS:  
5/8"  $\phi$  ON TOP, 3/4"  $\phi$  ON BOTTOM,  
LOCATED 12" ON CENTER

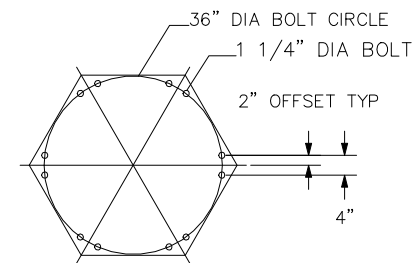

12 BOLT  
BASE BOLT PATTERN  
1 1/4" BASE PLATE THICKNESS AT ANCHOR BOLT  
VIEW A-A  
NOT TO SCALE

CREATED BY: HOOSIER CRANE SERVICE

**CONFIDENTIAL**

**GORBEL**

600 FISHERS RUN  
P.O. BOX 593  
FISHERS, NY 14453-0593

MODEL NO.: FS300-16-W18

CAPACITY: 2.000 TON  
SPAN: 16'-0"  
H.U.B.: 8'-0"

QUANTITY: 1  
SHIPPING WT.: 2549 LBS

DRAWN: lauyod

DATE: DEC 26, 2014

C.O.#: test

P/N: test.1A

NOTES:

- 1) JIB CRANE FOUNDATION REQUIREMENTS ARE BASED ON A SOIL PRESSURE OF 2500 LBS PER SQUARE FOOT. CONCRETE RECOMMENDED FOR JIB CRANE FOUNDATION IS 3000 LBS PER SQUARE INCH OF COMPRESSIVE FORCE.
- 2) DO NOT SCALE FROM THIS DRAWING.
- 3) OVERALL HEIGHT = 9'-6"